

# Surface Mount - Leaf Hinges

integrated stud mount - zinc

Access Hardware

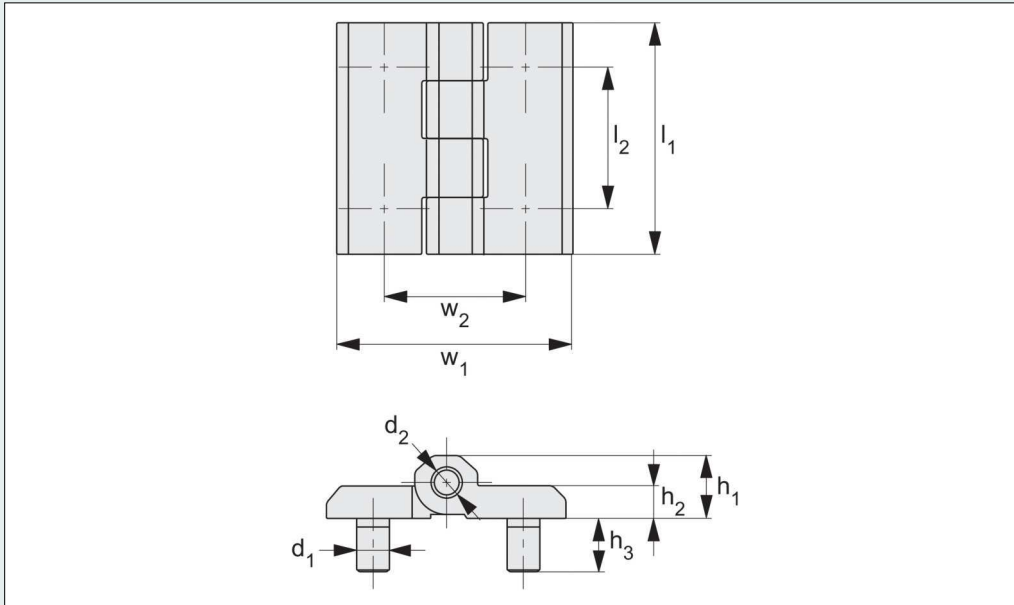

## HH0100

### Material

Body: die cast zinc, black powder coated.

Pin: steel, nickel plated.

### Technical notes

For plain/flush mounted doors, as well as electrical panels and covers. Opening angle 180°.

Order No.	Type	Size	$l_1$	$w_1$	$d_1$	$d_2$	$h_1$	$h_2$	$h_3$	$l_2$	$w_2$
HH0100.M0040	Equal	40 x 40	40	40	M6	5,3	9,0	5	10,0	25	25
HH0100.M0050	Equal	50 x 50	50	50	M6	6,3	11,5	6	12,5	30	30
HH0100.M0057	Equal	50 x 70	50	70	M6	6,3	11,5	6	12,5	30	56
HH0100.M0060	Equal	60 x 60	60	60	M6	8,4	15,0	8	16,5	36	36
HH0100.M0612	Equal	60 x 120	60	120	M8	8,4	15,0	8	16,5	36	88

